

SWITCH

LYNX 1005

Jensen[®]
OF SCANDINAVIA

QUICK GUIDE



THANK YOU FOR CHOOSING
JENSEN OF SCANDINAVIA

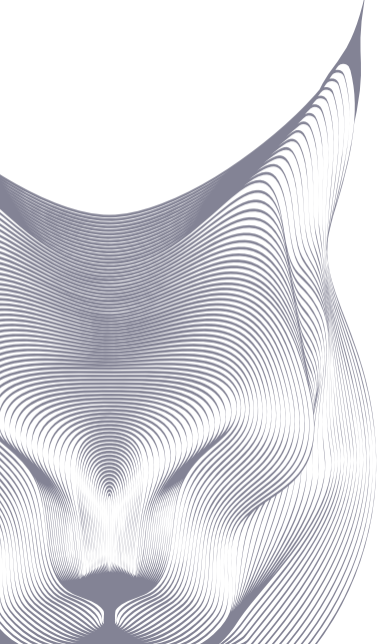

At Jensen of Scandinavia satisfied customers mean everything to us. We are always focused on meeting the requirements and wishes of our customers. Our goal is to be the obvious first choice, the best provider of customer service and offer products that are easy to use.

We would like to take this opportunity to once again thank you for choosing our product!

Best Regards

Jensen of Scandinavia

In the package





Before you start to install the switch, check that the following items are included in this package

1 x LYNX 1005

1 x Power adapter

1 x Quick guide

Contents

	Getting started	6
	Connecting devices	7
	Confirm connection	8
	Komme i gang	9 - 11
	Uppsättning	12 - 14
	Kom i gang	15 - 17
	Aloitus	18 - 20
	A bit of info	21
	Looking after your switch	22
	Safety	23



Getting started

Connect the power adapter to a nearby outlet and plug the DC connector into the LYNX 1005 as shown (1).
Using an Ethernet cable (not included) connect a port on the LYNX 1005 to one of your routers LAN ports (2).

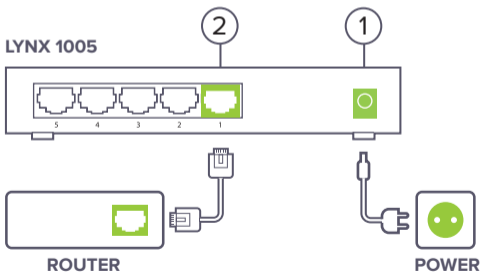

Connecting devices

Connect up to 4 more devices (2) using an Ethernet cable in any of the free ports (1).

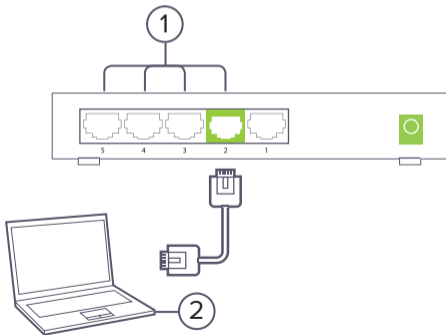

Confirm connection

Confirm a connection with the LYNX 1005 front LED for the connected port (1).



Off - No connection



On green - Gigabit connection



On orange - Fast connection



Flashing - Transmitting/receiving data



Komme i gang

Koble strømadapteren til en stikkontakt og plugg DC pluggen inn i Lynx 1005 som vist (1).

Koble en Ethernet-kabel (ikke inkludert) i en av portene i LYNX 1005 til en av LAN-portene på ruteren (2).

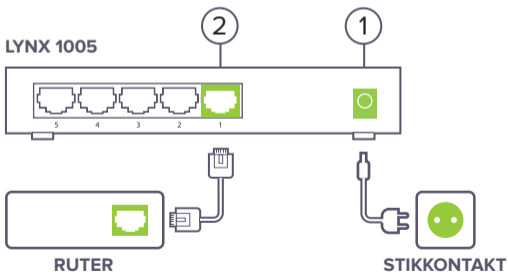

Koble til enhetene

Koble til opptil fire enheter (2) med en Ethernet-kabel i en av de ledige portene (1).

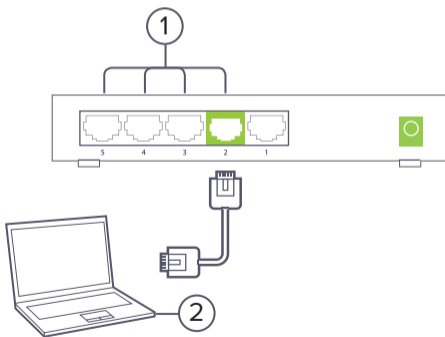

Bekreft tilkoblingen

Du kan bekrefte tilkoblingen til Lynx 1005 ved å sjekke tilsvarende LAN-port LED på forsiden av enheten (1).



Ingen lys - Ingen tilkobling



Grønn - Gigabit-tilkobling



Orange - Rask tilkobling



Blinkende - sender / mottar data



Uppsättning

Börja med att koppla ström-adaptern till närmsta eluttag och sätt sedan in din DC Kabel i din LYNX 1005 som visas (1). Använd en Ethernet kabel (Ingår ej) och anslut kabeln till en ledig LAN port på din LYNX 1005 och andra änden i din router (LAN port) (2).

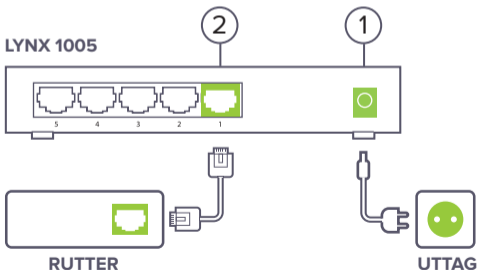

Anslut enheter

Du kan ansluta upp till 4:a enheter (2) genom att använda en Ethernet kabel i någon av dem lediga LAN portarna (1).

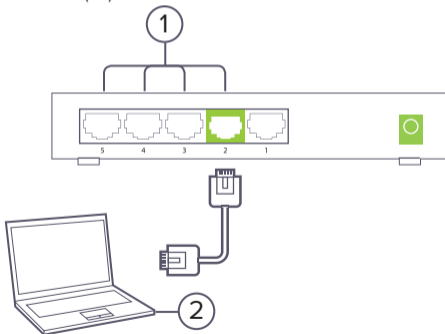

Bekräfta anslutningen

Bekräfta att enheten är ansluten genom att kolla om lamporna på framsidan lyser (LAN ports lamporna som indikeras av numer 1-5).



Av - Ingen anslutning



Grön färg - Gigabit anslutning



Orange färg - Snabb anslutning



Blinkade - Skickar/tar emot data



Kom i gang

Sæt strømforsyningen i en stikkontakt og sæt DC stikket i Lynx 1005 som vist (1).

Sæt et Ethernet-kabel (medfølger ikke) i en af porterne i LYNX 1005 til en af din routers LAN-porte (2).

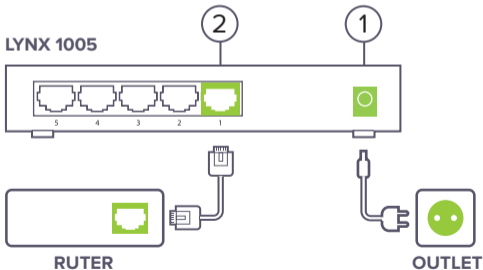

Tilslutning af enheder

Tilslut op til fire enheder (2) med et Ethernet-kabel i en af de ledige porte (1).

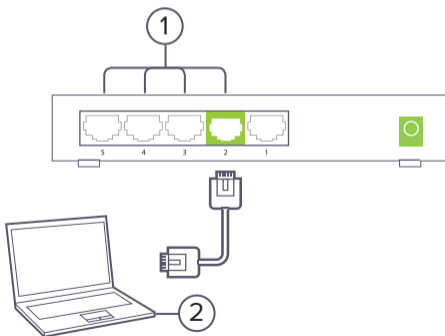

Bekræft forbindelse

Du kan bekræfte din forbindelse til Lynx 1005 ved at kontrollere den tilsvarende LAN port LED på forsiden af enheden (1).



Intet lys - Ingen forbindelse



Grøn - Gigabit forbindelse



Orange - Hurtig forbindelse



Blinkende – sender/modtager data



Aloitus

Kytke virtajohto lähimpään pistokkeeseen ja yhdistä muuntaja LYNX 1005 laitteeseen kuten 1 kohdassa. Yhdistä LYNX 1005 laitteen yhdestä portista Ethernet-kaapeli (ei sisälly pakkaukseen) yhteen porttiin reitittimessä (2).

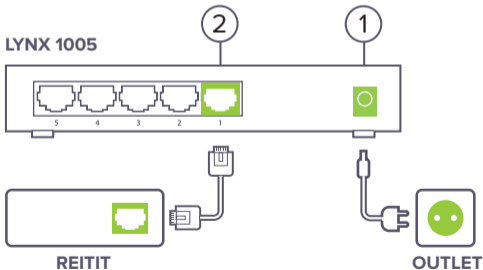

Laitteiden yhdistäminen

Yhdistä jopa neljä laitetta (2) Ethernet-kaapelilla vapaisiin portteihin (1).

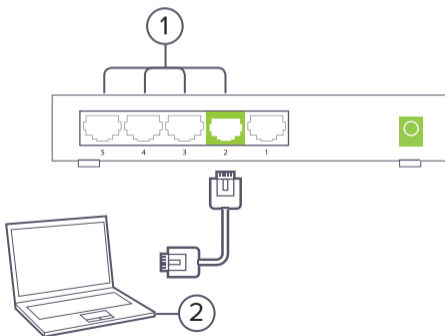

Varmista yhteyden toimivuus

Varmista yhteyden toimivuus LYNX 1005 kanssa etupaneelissa olevista LED-valoista (1).



Ei valoa - Ei yhteyttä



Vihreä valo - Gigabit yhteys



Oranssi valo - Nopea yhteys



Vilkkuva valo - Portissa liikkuu dataa
(lähetys/vastaanotto)

A bit of info

LYNX1005 is a powerful, high-performance Gigabit Ethernet switch, with 5 ports all capable of auto-detection of speed, duplex (NWay) or crossover (MDI-X). Put simply, the LYNX1005 will connect any device fully automatically without any configuration from you the user.

It is ideal for adding more wired devices to your current networks, simplifying your wired network into smaller segmented subnets. Gigabit Ethernet allows for improved performance enabling the bandwidth for demanding multimedia and imaging applications in use today.

Looking after your switch

Do not use power supplies or power cables other than those provided with this product.

The use of non-specified power supplies or power cables may create a safety hazard and/or impair equipment performance.

Do not wrap cords around Power Supply for storage. Do not drive, drag or place objects over cord.

Keep children and pets away from the unit and power cables. If you suspect damage always unplug the device from the mains.

Safety

This unit has no user serviceable parts, do not open. Use only genuine replacement parts from an approved dealer. Opening of this product by a non qualified engineer can risk electric shock.

Product usage restrictions:

This product is intended for indoor use only.

Power supply:

External Power Adapter

5V 1A

This product may be sold in all EU
and EFTA countries:

AT, BE, BG, CY, CZ, DK, EE, FI, FR, DE,
GR, HU, IS, IE, IT, LV, LI, LT, LU, MT,
NL, NO, PL, PT, RO, SK, SI, ES, SE,
CH, TR and GB

Jensen[®]
OF SCANDINAVIA

www.jensenofscandinavia.com



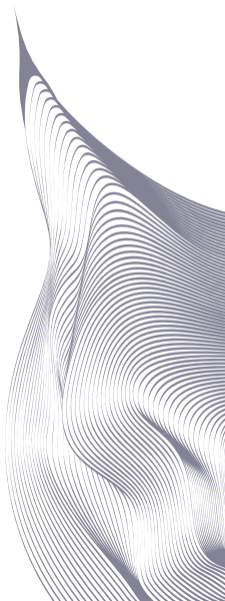

Jensen[®]
OF SCANDINAVIA

