



Heimgard

Wireless Switch 2 buttons

Quick start guide
version 1.0



Requires a
Heimgard hub

What is in
the box

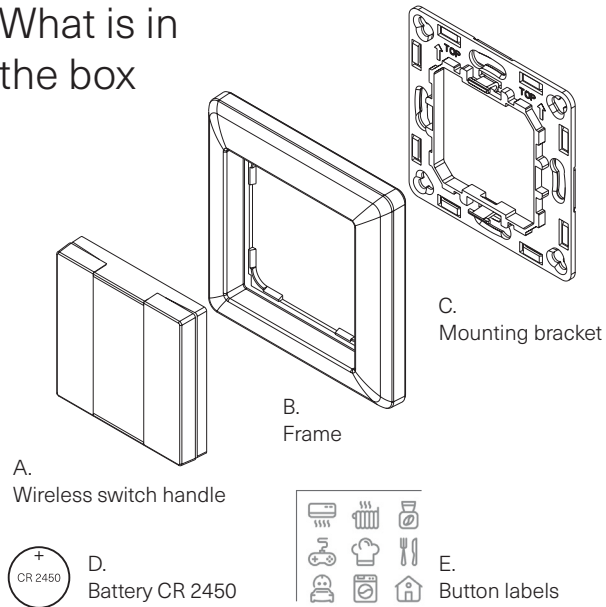

Device overview

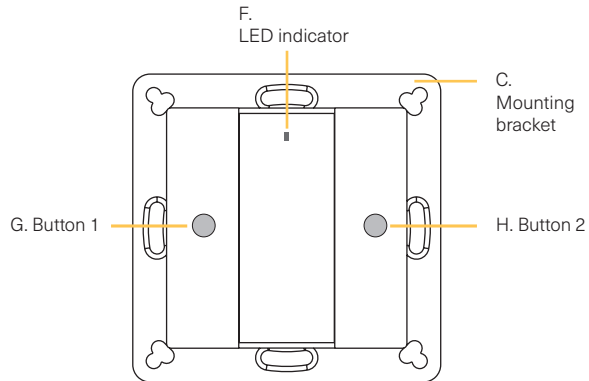

1. Remove the battery insulator

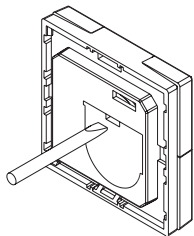

Use tool to open the silicone gel battery cover

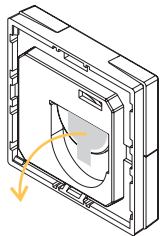

Pull out the battery insulator

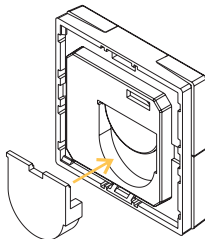

Install the silicone battery cover back

2. Open the Heimgard app and follow the steps listed here to connect to your device

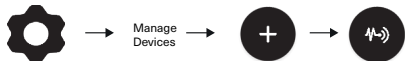

3.

Press and hold down both buttons (G + H) until the LED indicator (F) turns on.

Immediately short press the left button (G) to start pairing. The indicator (F) will now flash every second.

If the device isn't discovered in 20 seconds, repeat the process. The LED indicator (F) will blink 5 times quickly for successful pairing.

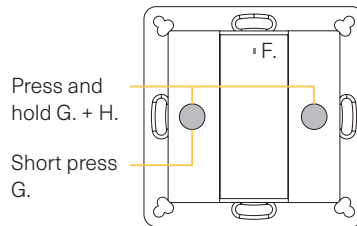

Your device will appear in the **Found Devices** list. Click **configure** to add the device to a specific room.

Wireless Switch Configuration

1. How to identify each button

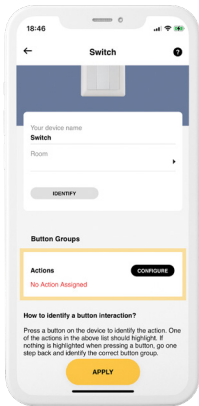

1. Press a button on the device you want to identify.
2. In the app you will now see an indication next to the button interface in the app.

This will help you identify which button you are assigning an action to.

2.

Add actions: You can add an action to a button by clicking Configure for each button group.

Select a function for each button.

Each button can be individually configured for device control, room control, scenes or alarm modes.

Scan QR-code for more detailed instructions on how to configure the buttons.



Or go to webpage:
<https://heimgard.com/configure-buttons>

Mounting

NOTE No wiring required.

1.

Install the controller to wall (2 options)

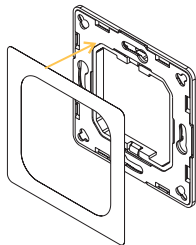

Option 1

Remove protective layer on the double-sided tape on the back of the wall mount and stick the bracket to the wall.

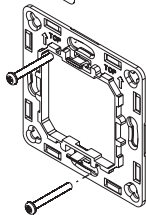

Option 2

Screw the bracket directly to the wall or mount it on a junction box

2.

After the bracket is fixed, clip the frame and control part to the bracket like illustrated:

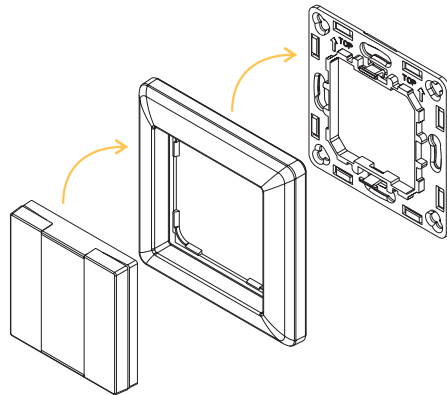

Mounting tips

Mounting with frames from other brands

This product can be installed in combination with other installation products like dimmers and thermostats.

The product fits in to traditional combination frames from various manufacturers.



Factory reset

Press and hold down both buttons (G + H) until the LED indicator (F) turns on.

Immediately press the left button (G) 5 times continuously. The indicator (F) will now flash 3 times quickly to indicate successful reset.

Press and hold G. + H.

Press G.
5 times
continuously

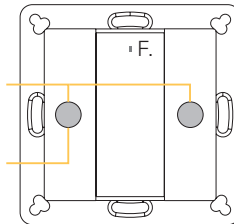

NOTE

All configuration parameters will be reset after the remote is reset or removed from the network.

Technical specifications

Protocol	Zigbee 3.0
Operation voltage	3VDC (CR2450)
Transmission frequency	2.4 GHz
Transmission range (free field)	30m
Protection type	IP20
Dimming range	0.1% - 100%
Dimensions	71.2 x 71.2 x 13.6mm

- Zigbee switch based on Zigbee 3.0
- 2.4 GHz global operation
- Long battery life mesh technology
- Transmission range up to 30m
- Compatible with universal Zigbee Gateway products

SAFETY WARNINGS

This device contains a button lithium battery that shall be stored and disposed properly. DO NOT expose the device to moisture.

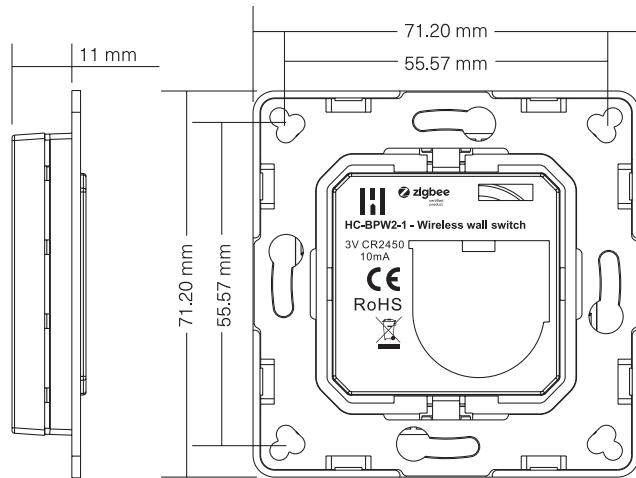

Need help?

Website: heimgard.com/support

Email: support@heimgard.com

Facebook: facebook.com/heimgardnorge/

Telephone: +47 649 44 422

Visit heimgard.com for more information and tips on how to use.

Important safety information

1. Read through these instructions and follow accordingly.
2. Clean only with dry soft cloth. Household cleaners and solvents can damage the finish on your device.
3. Do not install near any heat sources such as radiators, heat registers, stoves or other device that produce heat.
4. Do not use this device near water.
5. Warning: To reduce the risk of fire or electric shock, do not expose this device to rain or moisture.
6. Do not expose device to dripping or splashing.
7. Protect the attached cables from being walked on or pinched, particularly at plugs, convenience receptacles, and the point the exit the apparatus.
8. Only use attachments/accessories specified by the manufacturer.
9. Unplug this device during lightning storms or when unused for long periods of time.
10. All servicing should be performed by qualified service personnel. Servicing is required when the device has been damaged in any way.
11. Operating temperature: -10°C to +50°C
12. Operating relative humidity: < 95% RH (no condensation)



Dispose the product properly at the end of life. This is electronic waste which should be recycled accordingly.



Heimgard

 heimgard.com