

# INSTALLATION MANUAL

v.1.0



## DOOR LOCK

eng

Small and powerful smart door lock

## PRODUCT DESCRIPTION

This is the strongest, fastest, smallest and most secure smart lock on the market. You can lock and unlock the door through the app. Perfect when you need to let in a repairman but cannot stay at home. Don't be afraid of running out of power on your phone or the door lock - the door lock will still operate as normal with a key from the outside and manual from the inside.

## PREPARE FOR INSTALLATION

• Tools needed: Philips screwdriver and two pliers or a wire cutter

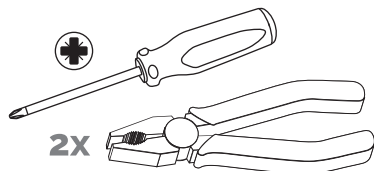

## GETTING STARTED

1. Make sure you have all parts ready to install the door lock  
1 Back plate, 1 tail piece, 1 tail piece plate, 1 tail piece adaptor, 2 breakable long screws, 2 short screws and the door lock inc 4 CR12A lithium batteries.

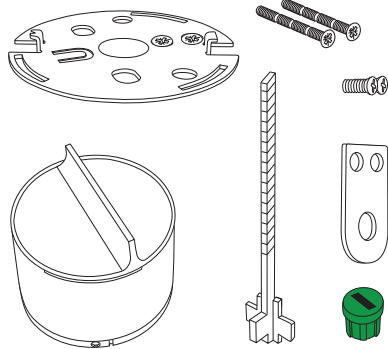

2. Secure the front lock. Before removing your existing lock, use tape to secure the outside keyhole. This will keep it in place as you remove the screws on the inside.

3. Remove the inside thumb-turn. First you have to remove the inside thumb-turn. Set aside the screws. You'll reinstall them in step

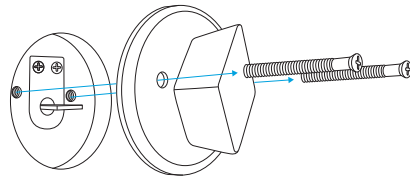

4. Normal tailpiece length. Most doors have tailpieces that extend 10 mm from the doorplate. They will fit the door lock without need for any adjustments to their length! If the tailpiece is less than 10 mm from the door surface, an extra tailpiece can be found in the Door lock box. The door lock works with a tailpiece length up to 35 mm at maximum. If the tailpiece length exceeds 35 mm you will have to shorten it. (See illustration in step 7). **You then need to shorten the new tailpiece after you have mounted the back plate.**

5. Mount the tail piece with the tail piece plate and the short screws

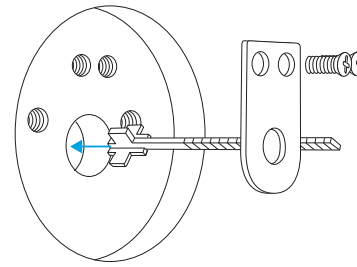

6. Find the backplate in the door lock box and remove the paper from the three stickers on the backside of the backplate. Place the backplate where the thumb-turn used to be. The round hole in the middle is for the tailpiece. Use the 2 screws (breakable long screws) from the thumb-turn to attach the backplate.

7. Make sure the tail piece is the correct length. To avoid damaging the door lock you will have to shorten the new tailpiece to max. 35 mm from the door surface. Use two pliers or a wire cutter to shorten the tailpiece.

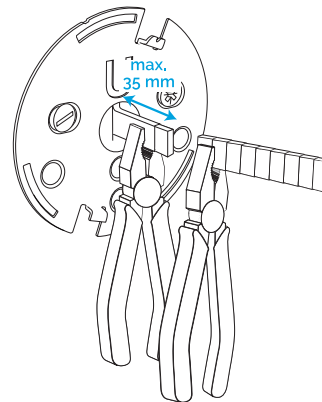

8. Attach the tailpiece adaptor. Take the green tailpiece adaptor from the door lock box and insert the tailpiece adaptor in the center tube on the backside of the door lock. Press on the adaptor until a click ensures it is fixed firmly to the door lock.

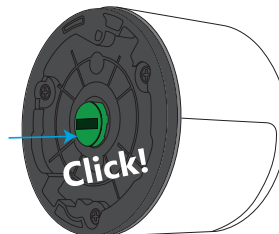

9. Fit the door lock over the backplate with the battery cover facing down, the tailpiece sliding into the adapter and the backplate notches into the back of the lock.

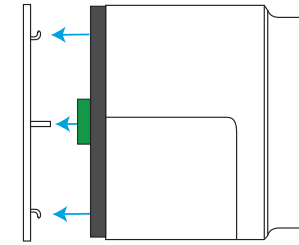

10. Find the small marking at the edge of the backplate and align it with the hole in the cover ring surrounding the door lock. Now you are sure to hit the notches on the backplate with the door lock.

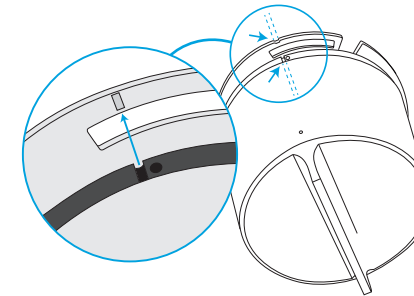

11. Turn the door lock clockwise until it clicks to fasten it to the backplate. NOTE: If you need to unfasten and retry, see "Uninstall instructions".

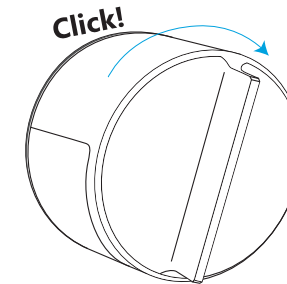

12. Activate the batteries. Pull out the plastic tab to activate the batteries. A light will flash to confirm the door lock is ready. Note: If the batteries are disconnected, you will have to re-calibrate the door lock.

13. Open the app and search for new device. Put the door lock in discover mode by pushing a small pin in the button hole on the door lock. One click will turn in the green LED indicating that the lock is ready to be paired with Wattle. It will flash during scan. Note: Leave the door open, so the lock isn't influenced when calibrated.

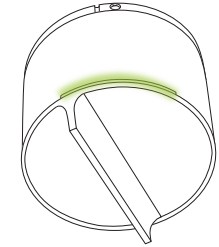

14. Configure the device and save. You are now ready to use the door lock with Wattle.

## RESETTING

This action will delete all settings in the door lock. Click 10 times, wait 5 seconds. Now the door lock blinks red and resets the door lock.

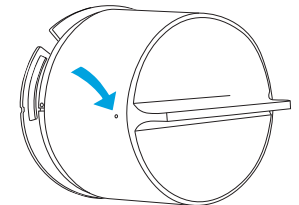

## LED LIGHT MODES

- Constant red till light finishes: Lock has successfully locked.
- Constant green till finishes: Lock has successfully unlocked
- Constant white for 3 seconds: Power on. Batteries are activated
- Red light flashes every 5 minutes: Critical battery level
- Constant purple: Firmware is being updated
- Blue light flashes: Settings are changed/saved

## HOW TO OPERATE THE DOOR LOCK

You can control the door lock via a switch reached through the small hole on top of the lock. You have 5 seconds before the door lock engages the activity, giving you plenty of time to click the switch the right number of times. Notice: If you make a wrong number of clicks you can cancel by clicking 7 times.

- When you need to set the door lock in ex/inclusion mode, click the switch one time, wait 5 seconds until the door lock blinks green. Now it is in ex/inclusion mode and you have 30 seconds to pair the door lock with a gateway.
- Turn the door lock completely into unlocked position, then click twice. Wait 5 seconds until it flashes yellow, then turn the doorlock into locked position and click once.
- Turn the door lock manually until the door is unlocked and leave the door open while calibrating. Lift the handle if needed. Now click 3 times, after 5 seconds the door lock will calibrate.
- If you make a wrong number of clicks you can cancel by clicking 7 times.

### DISPOSAL

Dispose the product properly at the end of life. This is electronic waste which should be recycled.

## OTHER INFORMATION

- ZigBee Home Automation 1.2 certified.



### All rights reserved.

Wattle assumes no responsibility for any errors, which may appear in this manual. Furthermore, Wattle reserves the right to alter the hardware, software, and/or specifications detailed herein at any time without notice, and Wattle does not make any commitment to update the information contained herein. All the trademarks listed herein are owned by their respective owners.

Copyright © Wattle

**wattle**