

## INSTALLATION MANUAL

v.1.0

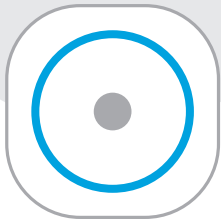

## MOTION SENSOR

eng

*The ultimate solution to monitoring the status of your home*

## PRODUCT DESCRIPTION

The Motion Sensor from Wattle can detect occupancy, movement, light and temperature. Place the battery powered Motion Sensor on a table or shelf, or use the mounting screws and place it flat on the wall, flat on the ceiling or in the corner.

The Motion Sensor can be integrated with other ZigBee based products for smart home, smart energy, healthcare and building management.

The Motion Sensor can detect movement at a distance of up to 6 meters.

## PRECAUTIONS

- Do not remove the product label as it contains important information.
- Do not place the Motion Sensor close to a heating/cooling source, as it may activate the temperature sensor.
- Do not place the Motion Sensor in direct sunlight or bright light.

- Avoid placing the Motion Sensor close to electromagnetic fields.
- Do not paint the sensor.

## GETTING STARTED

1. Remove the magnetic mounting base and open the casing of the sensor.

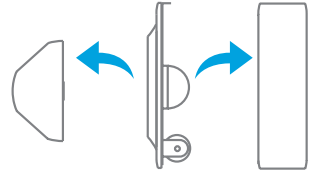

2. Insert the batteries respecting the polarities.
3. The motion sensor will start searching (up to 15 minutes) for a ZigBee network to join.
4. Make sure that the ZigBee network is open for joining devices and will accept the Motion Sensor.
5. While the Motion Sensor is searching for a ZigBee network to join, the LED flashes red.



6. When the LED stops flashing, the Motion Sensor has successfully joined the ZigBee network.

## PLACEMENT

### PLACE THE SENSOR

- Place the sensor indoors at a temperature between 0-50°C.
- Its angle of detection from above, the sides and below must be 45°.
- The Motion Sensor must be placed in a location with a clear view of the monitored area and the windows.
- The distance from the Motion Sensor to a fireplace or a stove must be at least four meters.
- Most favourable placement of the Motion Sensor is in a corner of the room, closest to the ceiling, as the Motion Sensor reacts optimally to crosswise movement.

- The Motion Sensor must be reachable for battery testing and maintenance.
- Place the sensor free of curtains and other obstacles.

## MOUNTING

### MAGNETIC BASE

1. Detach the sensor from the magnetic mounting base by pulling it away.

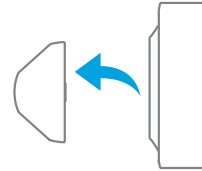

2. Use the magnetic mounting base to mark the screw holes on the corner of the ceiling or a wall.
3. Use enclosed screws and plugs to install the mounting base on the marked place.

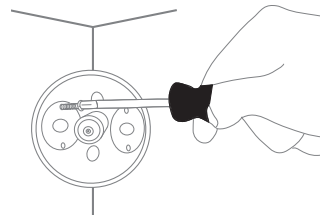

4. Attach the sensor to magnetic mounting base.

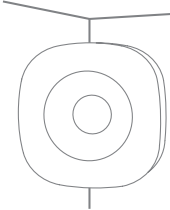

### FIXED MOUNTING WITH SCREWS

1. Remove the magnetic mounting base and open the casing of the sensor.

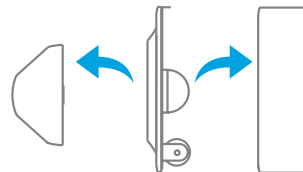

2. Use the sensor part with holes to mark the screw holes on a flat ceiling or a wall.

3. Use enclosed screws and plugs to install the mounting base on the marked place.

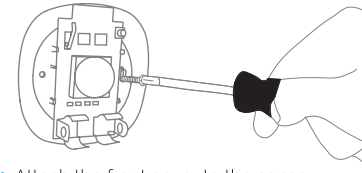

4. Attach the front cover to the sensor.

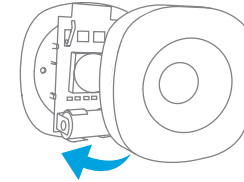

### MAGNET

1. Detach the magnetic mounting base from sensor by pulling it away.

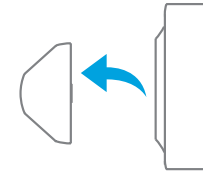

2. Unscrew the small magnet from the mounting base.

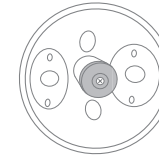

3. Screw the magnet on a ceiling or a wall.

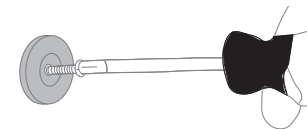

4. Attach the sensor to the magnet.

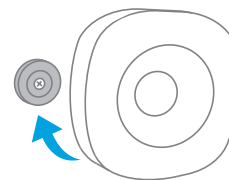

### STAND

1. Insert the plastic stand in the opening on the back of the sensor as shown on the drawing.
2. Place the standing sensor on the shelf or on a desk.

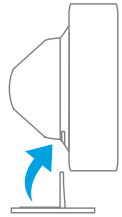

## RESETTING

Resetting is needed if you want to connect your Motion Sensor to another gateway, or if you need to perform a factory reset to avoid abnormal behavior.

### STEPS FOR RESETTNG

1. Detach the sensor from the magnetic mounting base and/or open the casing.
2. Check that the battery is inserted correctly.
3. Press and hold the menu button until the red LED starts to flash.

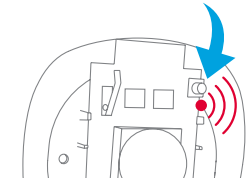

4. Release the button during flashing.
5. Resetting process is complete when the red LED starts to blink every second.

## FAULT FINDING & CLEANING

- In case of a bad or weak signal, change the location of the Motion Sensor. Otherwise you can relocate your gateway or strengthen the signal with a smart plug.
- If the search for a gateway has timed out, a short press on the button will restart it.



## BATTERY REPLACEMENT

**CAUTION:** RISK OF EXPLOSION IF BATTERIES ARE REPLACED BY AN INCORRECT TYPE. DISPOSE OF THE BATTERIES IN ACCORDANCE WITH THE INSTRUCTIONS.

**CAUTION:** When removing cover for battery change - Electrostatic Discharge (ESD) can harm electronic components inside.

1. To replace the battery, detach the Motion Sensor from the mounting base and open the casing.
2. Replace the battery respecting the polarities. The Motion Sensor uses 1xCR123 battery.
3. Close the casing of the sensor.

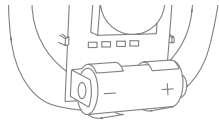

## DISPOSAL

Dispose the product and battery properly at the end of life. This is electronic waste which should be recycled.

## FCC STATEMENT

Changes or modifications to the equipment not expressly approved by the party responsible for compliance could void the user's authority to operate the equipment.

**NOTE:** This equipment has been tested and found to comply with the limits for a Class B digital device, pursuant to Part 15 of the FCC Rules. These limits are designed to provide reasonable protection against harmful interference in a residential installation. This equipment generates, uses and can radiate radio frequency energy and, if not installed and used in accordance with the instructions, may cause harmful interference to radio communications. However, there is no guarantee that interference will not occur in a particular installation.

If this equipment does cause harmful interference to radio or television reception,

which can be determined by turning the equipment off and on, the user is encouraged to try to correct the interference by one or more of the following measures:

- Reorient or relocate the receiving antenna.
- Increase the separation between the equipment and receiver.
- Connect the equipment into an outlet on a circuit different from that to which the receiver is connected.
- Consult the dealer or an experienced radio/TV technician for help.

This device complies with FCC RF radiation exposure limits set forth for an uncontrolled environment. The antenna used for this transmitter must be installed to provide a separation distance of at least 20 cm from all persons and must not be co-located or operating in conjunction with any other antenna or transmitter.

This device complies with part 15 of the FCC Rules. Operation is subject to the following two conditions:

1. This device may not cause harmful interference, and
2. this device must accept any interference received, including interference that may cause undesired operation.

## CE CERTIFICATION

The CE mark affixed to this product confirms its compliance with the European Directives which apply to the product and, in particular, its compliance with the harmonized standards and specifications.



### IN ACCORDANCE WITH THE DIRECTIVES

- Radio & Telecommunications Terminal Equipment Directive 2014/53/EU
- EMC Directive 2014/30/EU
- RoHS Directive 2011/65/EU

## OTHER INFORMATION

- ZigBee Home Automation 1.2 certified.



### All rights reserved.

Wattle assumes no responsibility for any errors, which may appear in this manual. Furthermore, Wattle reserves the right to alter the hardware, software, and/or specifications detailed herein at any time without notice, and Wattle does not make any commitment to update the information contained herein. All the trademarks listed herein are owned by their respective owners.

Copyright © Wattle

wattle