

INSTALLATION MANUAL

v.1.0

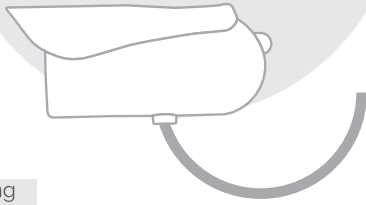

eng

OUTDOOR CAMERA

Monitor
your
driveway
or backyard

PRODUCT DESCRIPTION

See what is happening when you are not there. Recording on motion detection. The sleek compact design of Y-cam Protect Outdoor Camera will complement the exterior of your property. This robust outdoor security camera is weatherproof to IP66 international standards and is perfect for watching driveways, observing gardens and outbuildings.

WHAT'S IN THE BOX

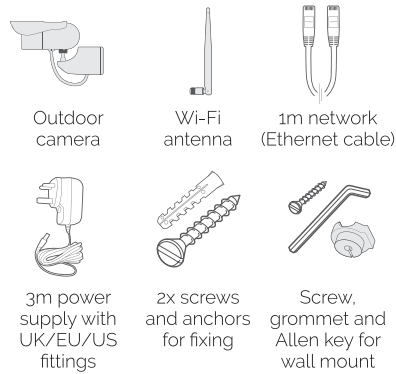

BOTTOM VIEW

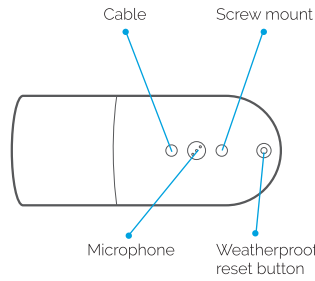

SETTING UP YOUR CAMERA

It's important your camera is configured according to your individual requirements. Once you have completed the set up process it is advisable to test it so you are satisfied it will do what you need.

1. Cable access

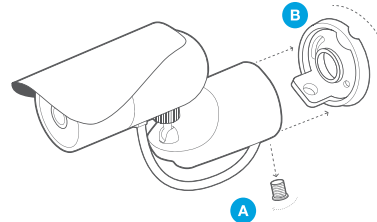

- A. Unscrew the stand cap screw (anti-clockwise)
- B. Twist the stand cap to remove the cables (anti-clockwise)

2. Attach the Wi-Fi antenna (if using Wi-Fi)

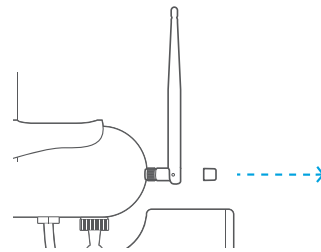

Remove the protective boot and screw in the Wi-Fi antenna in its place (clockwise)

3. Connect the camera to main router and power ON.

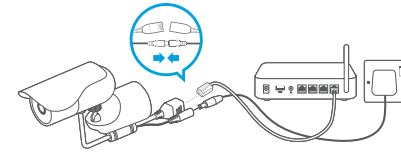

Use the network (Ethernet) cable supplied to connect your camera to a spare network port on the back of your router. Connect the power.

The Status LED on the front of the camera will start flashing. Wait for it to start communicating with our cloud platform, once connected the status LED will go green. This may take a few minutes.

INSTALLATION AND PLACEMENT TIPS

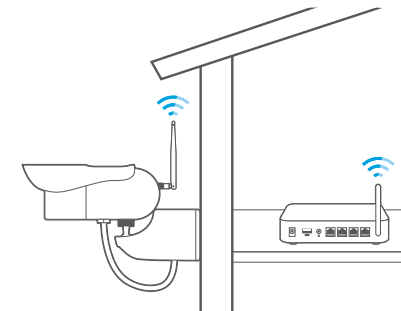

Connect on Wi-Fi or using extender

Using a Wi-Fi connection for your camera is a popular option, but thick or insulated walls can greatly reduce the signal strength. Always test the camera can reach your network before installation.

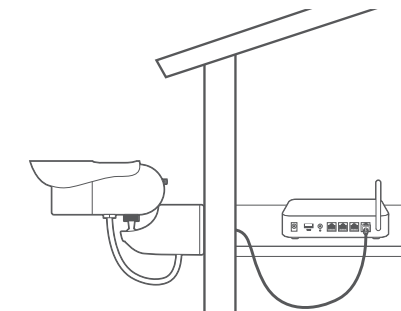

Connect by network cable or PoE

Ethernet or Power over Ethernet* (PoE) connections are the most reliable. PoE allows you to also power the camera from a PoE switch/router, so only an ethernet cable is required to reach the camera.

*A PoE Injector or Switch that is 802.3af compliant and a minimum 13W power per port is required

Important information

- If using Wi-Fi, make sure you remove the protective boot from the Wi-Fi antenna mounting screw before attaching the antenna.
- We recommend placing the camera no further than 10m away from your router; closer if there are obstacles in the way such as walls, doors or ceilings.
- Outside of this range, we recommend using an Ethernet connection, Power over Ethernet, installing a Wi-Fi signal extender or repeater, or using HomePlug/Powerline technology.
- The camera is only compatible with 2.4GHz network. If your router is using the 5GHz band, please ensure it is operating in a mixed mode and with the frequencies operating independently from one another.
- Make sure your camera is connecting to your network properly before following the rest of installation procedure and securely fastening your camera to the wall.

INSTALLING YOUR CAMERA ON A WALL

If using Wi-Fi, before mounting, ensure your camera is in a position where Wi-Fi is accessible.

1. Work out where you want the camera to be placed, and drill two holes for the stand cap. Prepare your cabling to the centre of this point, either along the wall or through the wall (see Option 1 and 2) (Power cable if using Wi-Fi, power cable and/or Ethernet cable if using network connection or PoE), bearing in mind the cabling will be going straight in to the back of the camera - so all excess cable should be removed, with the cable connectors as close to the centre of the base plate as possible.

YOUR CAMERA

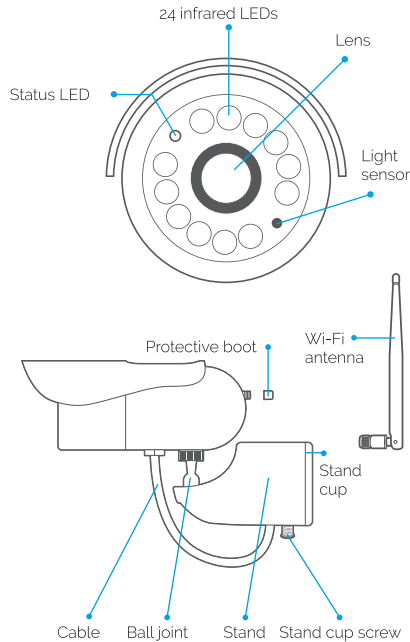

TOP VIEW

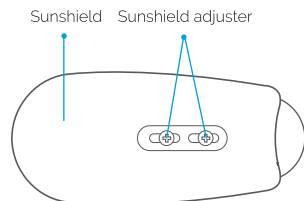

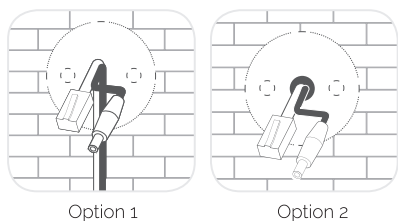

Option 1

Option 2

2. Position the rubber grommet over the cables between the two screws, channeling the cables through the groove if required. The grommet only fits into the stand cap one way.

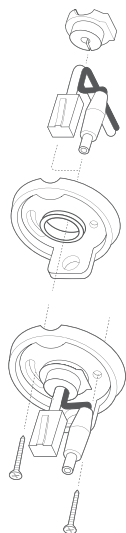

3. Prepare the camera and stand for mounting (attach Wi-Fi aerial, tighten ball joints slightly, move sun shield, etc. as needed for your setup)

Note: Ensure all excess cable is removed as excess cable will not fit in the camera mount.

4. Connect the cable from the camera to the cabling in step 2. Please make sure the power connector is pushed in securely.

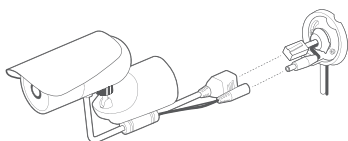

5. Position the cable from the base of the camera through the base of the stand and insert any extra cable into the stand.

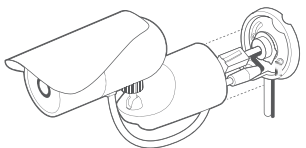

6. Turn the camera and stand anti-clockwise and place over the stand cap, and then turn clockwise to lock into place. If you have any issues locking the stand into the place, make sure the cable from the camera going into the base is not preventing the stand from locking into place.

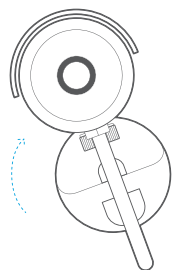

7. Insert the stand cap screw and tighten it in order to firmly secure the camera and stand to the wall. Readjust the camera's ball joint to capture the desired view. Affix any loose cabling to the wall.

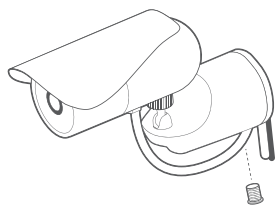

MOTION ALERT & NOTIFICATION TIPS

Outdoor camera is equipped with sophisticated motion sensor which detects when motion is happening and can alert you instantly by push notifications or e-mail.

If you want to receive alerts every time motion is detected, you may want to consider following tips so that you achieve the best results and reduce the number of false alerts.

-  Active pets (or children) may activate the motion recording by accident.
-  Movements near busy doors or windows may set off multiple alarms.
-  Moving cars or headlights may cause unwanted motion recordings.
-  Sunlight and reflections may trigger motion alerts.
-  IR lights will reflect when pointed at glass and may create false alarms.

TECHNICAL INFORMATION

CAMERA

Image quality: 1 megapixel 1/4" CMOS lens, 1280x720 resolution, Far Focus lens

Viewing angle: Horizontal: 100°, Vertical: 56°, FOV: 109°

Night vision: 24 infrared LEDs, up to 15m

Audio: Built-in microphone





Weatherproof: IP66-rated - waterproof & weatherproof

Connectivity: Wi-Fi 802.11 b/g/n 2.4GHz, Ethernet, PoE

Power: 100-240V AC, 12V, 3.75W

Size & weight: 110 x 65 x 200mm, 410g

LED STATUS LIGHT

-  **Solid green**
Online / booting up
-  **Blinking green**
Sending video
-  **Blinking red**
Establishing connection / connection lost
-  **No light**
No power

SAFETY INFORMATION

- Do not try to disassemble
- Keep the power supply dry and avoid contact with liquid
- Small parts may be a choking hazard, keep away from children
- Only use approved accessories and power supplies
- Do not cover the camera, infrared lights produce heat, which may create a fire hazard
- Ensure the camera is properly attached to the supplied stand before final installation and positioning
- Compliance is only assured by using the included power supply

All rights reserved.

Wattle assumes no responsibility for any errors, which may appear in this manual. Furthermore, Wattle reserves the right to alter the hardware, software, and/or specifications detailed herein at any time without notice, and Wattle does not make any commitment to update the information contained herein. All the trademarks listed herein are owned by their respective owners.

Copyright © Wattle

wattle