

# INSTALLATION MANUAL

v.1.0



eng

## SMOKE ALARM

Product reference 2102-002

Optimal fire detection

## PRODUCT DESCRIPTION

The Smoke Alarm will warn occupants about smoke, using a loud siren. While away, they will be instantly notified of a potential fire through an internet-connected gateway.

Via ZigBee communication, the Smoke Alarm can activate sirens of other Smoke Alarms in the building. Moreover, the Smoke Alarm will report the status and temperature every two minutes via your IoT system.

The smoke alarm is designed for private homes, camping trailers, mobile homes and caravans. It is not recommended for boats.

## PRECAUTIONS

- Do not remove the product label as it contains important information.
- Do not paint the alarm.
- Avoid placing the Smoke Alarm in dusty rooms.
- Do not place the alarm in a kitchen, garage, or in other places where damp, gases and smoke naturally occur.

## GETTING STARTED

1. Pull out the battery isolation strip as shown.

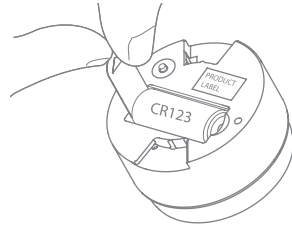

2. The Smoke Alarm will now start searching (up to 15 minutes) for a ZigBee network to join.
3. Make sure that the ZigBee network is open for joining devices and will accept the Smoke Alarm.
4. While the Smoke Alarm is searching for a ZigBee network to join, the LED button flashes red.

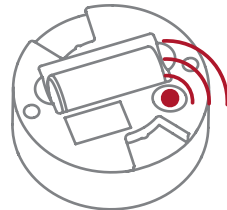

5. When the LED button stops flashing, the Smoke Alarm has successfully joined the ZigBee network.

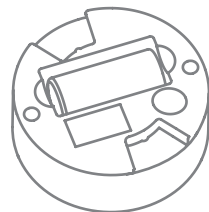

## PLACEMENT

- Place the Smoke Alarm indoors at a temperature between 0-50°C.
- It is important to place smoke alarms in bedrooms and on exit routes.
- The distance between the smoke alarm and walls, ventilation or other obstacles, should be at least 50 cm.
- The distance between the alarm and a fireplace or stove should be at least 4 meters.
- Rooms larger than 80 m<sup>2</sup> require several smoke alarms in order to sustain full fire safety.

- The alarm should be placed within reach for battery testing and maintenance.
- The alarm should not be placed at the top of high pointed ceilings or in ceiling corners or within 50 cm of a wall.

### PLACEMENT EXAMPLES

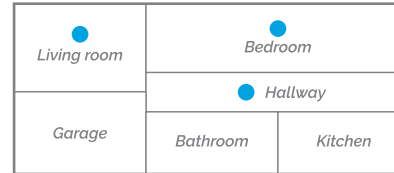

### RECOMMENDED LOCATION

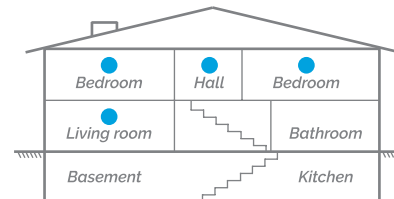

### RECOMMENDED LOCATION

### CEILING PLACEMENT

The smoke alarm should be a minimum of 50 cm from the wall.

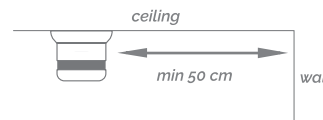

### WALL PLACEMENT

The smoke alarm should be between 30 and 50 cm from the ceiling.

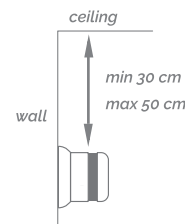

There should be at least one smoke alarm per floor, and a maximum distance between smoke alarms of 10 meters.

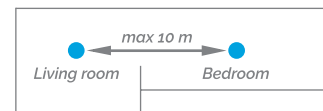

## MOUNTING

1. Detach the alarm from the mounting base by twisting counterclockwise.
2. Use the mounting base ring to mark the screw holes on the ceiling or on the wall.

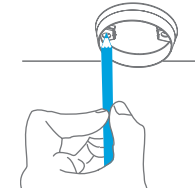

3. Use enclosed screws and plugs to install the mounting base on the marked position.

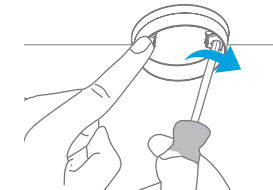

4. If the battery is missing or inserted incorrectly, it will be impossible to attach the alarm in the mounting base.
5. Attach the alarm by twisting clockwise until it clicks.

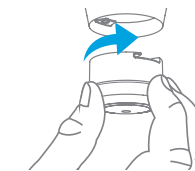

## TESTING

- Always test the working order of the smoke alarm after installation or battery change.
- When pressing the alarm button, the alarm sound should be heard.
- A network alarm test can be performed by holding down the alarm button for at least 6.5 seconds (count 2 sets of 3 sound sweeps).
- A test message will be sent over the ZigBee network.
- Test all of your alarms once a week to ensure they are functioning correctly.



## RESETTING

Resetting is needed if you want to connect your smoke alarm to another gateway or if you need to perform a factory reset to eliminate abnormal behavior.

### STEPS FOR RESETTING

1. Detach the alarm from the mounting base by twisting it counterclockwise.
2. Press and hold the LED button until it flashes continuously.
3. Release the button.
4. Resetting process is complete when the LED starts to blink.

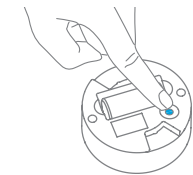

## MODES

### SEARCHING GATEWAY

- Red LED light in the back of the device is flashing every second (up to 15 minutes).

### NORMAL MODE

- Front LED is flashing every 45 seconds.

### ALARM MODE

- The simultaneous flashing of the front red LED and sounding of intermittent audible signal.
- When smoke is detected, the alarm will sound.
- Press the "button/top" of the Alarm to acknowledge and stop the siren. The following 10 minutes, it will block alarms, allowing time to ventilate the smoke.

### LOW BATTERY MODE

- Simultaneous audible signals and front LED flashes every 45 seconds, means that the battery should be replaced.

### REPLACE DEVICE MODE

- NOT simultaneous audible signals and front LED flashes every 45 seconds, means that the device should be replaced. The life expectancy of smoke alarms is generally 10 years, after which point their sensors begin to lose sensitivity.

## FAULT FINDING & CLEANING

- Dust particles in the smoke chamber can be removed by vacuuming the mesh.
- High humidity condensing can be resolved by drying the smoke alarm.
- If the smoke alarm does not work when the test button is pushed, the probable cause is a faulty battery. Replace the battery if it is worn out.
- In case of a bad or weak signal, change the location of the smoke alarm. Otherwise you can relocate your gateway or strengthen the signal with a smart plug.
- If the search for a gateway has timed out, a short press on the LED button will restart it.

## BATTERY REPLACEMENT

**CAUTION:** RISK OF EXPLOSION IF BATTERIES ARE REPLACED BY AN INCORRECT TYPE. DISPOSE OF THE BATTERIES IN ACCORDANCE WITH THE INSTRUCTIONS.

**CAUTION:** When removing cover for battery change - Electrostatic Discharge (ESD) can harm electronic components inside.

1. To replace the battery, detach the smoke alarm from the mounting base by twisting counter-clockwise.
2. Replace the battery respecting the polarities. The Smoke Alarm uses 1xCR123 battery.

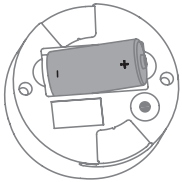

3. Attach the alarm in the mounting base by twisting clockwise until it clicks, and test the alarm.

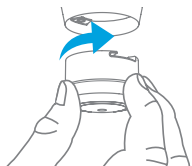

## DISPOSAL

Dispose the product and battery properly at the end of life. This is electronic waste which should be recycled.

## OTHER INFORMATION

- Note local country regulations regarding installation of mains powered alarms in new buildings.
- Note local regulations about information to your insurance company regarding installed smoke alarms.
- If a smoke alarm is activated, the gateway will start the alarm on all other smoke alarms in the network. This is dependent upon that the gateway supports this functionality.

## CE CERTIFICATION

The CE mark affixed to this product confirms its compliance with the European Directives which apply to the product and, in particular, its compliance with the harmonized specifications of standard EN14604:2005 + AC:2008 relating to Construction Products Regulation 305/2011.



## OTHER CERTIFICATION

- ZigBee Home Automation 1.2 certified.
- RoHS compliant according to the EU Directive 2002/95/EC
- DIN EN 14604
- EMC and EMF
- DIN 14676 certified



All rights reserved.

Wattle assumes no responsibility for any errors, which may appear in this manual. Furthermore, Wattle reserves the right to alter the hardware, software, and/or specifications detailed herein at any time without notice, and Wattle does not make any commitment to update the information contained herein. All the trademarks listed herein are owned by their respective owners.

Distributed by Wattle  
Per Kroghs Vei  
1065 Oslo  
Norway  
www.wattle.com

Smoke alarm developed by CAVIUS Aps  
Julsovej 16  
8660 Silkeborg  
Denmark.  
Manufactured in P.R.C.

**CAVIUS**

**wattle**